



INLINE MIXED FLOW FANS

*The solution for low demand ventilation in
general commercial and residential systems.*

**SIGRIST
DESIGN** PTY. LTD.

Sigrist Design is an Australian owned and operated company with over 30 years of experience designing and manufacturing custom ventilation solutions.

With a head office and manufacturing facility located in Queensland, dust management and air filtration products are our focus. The Sigrist Design team has experienced design engineers, sheet metal fabricators, welders and site installation crews.

Predominantly dealing in ventilation, fans, air filtration and dust collection with a majority of products being manufactured in house, we design and manufacture for industrial, commercial, building and construction markets. Our team of salespeople, workshop technicians and engineers are experienced in these fields and more than capable of tackling different and challenging design problems that lie within our diverse manufacturing capabilities.



SIM-B RANGE



*Our silent inline mixed flow fans provide **ultra** low noise levels. Using an integral silencer built into the fan housing, our silent mixed flow fans come complete with a lead, plug and a pre-wired two speed switch, providing high and low speeds depending on your requirements.*

The motor housing can unclip from duct connections for ease of service. This whisper quiet solution is used for lower air volume ventilation in general commercial and residential systems. Commonly used in room air transfer, toilet exhaust and general supply or exhaust ventilation applications where performance and sound levels are critical, within a restricted space. The terminal block can be rotated to four positions.

IM-B RANGE



Our inline mixed flow fans provide low noise levels and incorporate a hybrid impeller design. Supplied complete with a lead, plug and a pre-wired two speed switch, providing high and low speeds depending on your requirements.

The motor housing can unclip from duct connections for ease of service. This quiet solution is used for lower air volume ventilation in general commercial and residential systems. Commonly used in room air transfer, toilet exhaust and general supply or exhaust ventilation applications where performance levels are critical within a restricted space.

FEATURES



Highly suited to areas with restricted space where the compact design comes into its own, including ceiling spaces and between false ceilings.



High or low speed operation.



Speed controllable with potentiometer controller (suitable for high fan speed setting only).



Compatible with 100mm duct up to 315mm duct.



Can be installed in parallel or series configuration for higher pressures or flows.



Easy motor/impeller dismount system.



Airflow tests to ISO 5801



Noise tests to ISO 13347-2:2004 and ISO 10302



SIM-B RANGE



FEATURES

The SIM-B range is a silent inline duct silent mixed flow fan, which is used for general ventilation when low noise is required.

APPLICATION

This fan can be applied in;

- Hospitals
- Surgical wards
- Libraries
- Offices





CONSTRUCTION

This silent inline mixed flow fan is manufactured from a polymer coated steel casing with a plastic impeller.

MOTORS

There is one motor option available for this inline fan. This is a single-phase motor, with two speed options which has been pre-installed by the manufacturer.

SPECIAL FEATURES

-  IPX4 protection rating
-  High quality bearings
-  Dual speed control
-  50 mm thick sound/thermal insulation
-  Thermal overload switch

DIMENSIONS

| MODEL | B | B1 | D | H | L |
|--------------|-----|-----|-----|-----|-----|
| SIM-B-150-2E | 247 | 273 | 148 | 263 | 579 |
| SIM-B-200-2E | 293 | 386 | 198 | 295 | 550 |
| SIM-B-250-2E | 358 | 445 | 248 | 360 | 658 |
| SIM-B-315-2E | 432 | 520 | 313 | 434 | 780 |

HOW TO ORDER

 DIAMETER

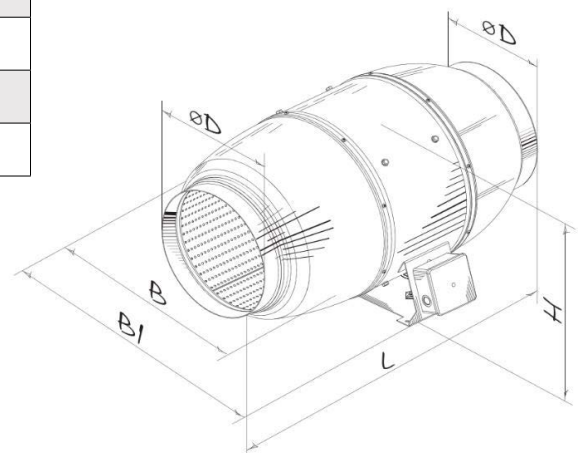

PERFORMANCE CURVE

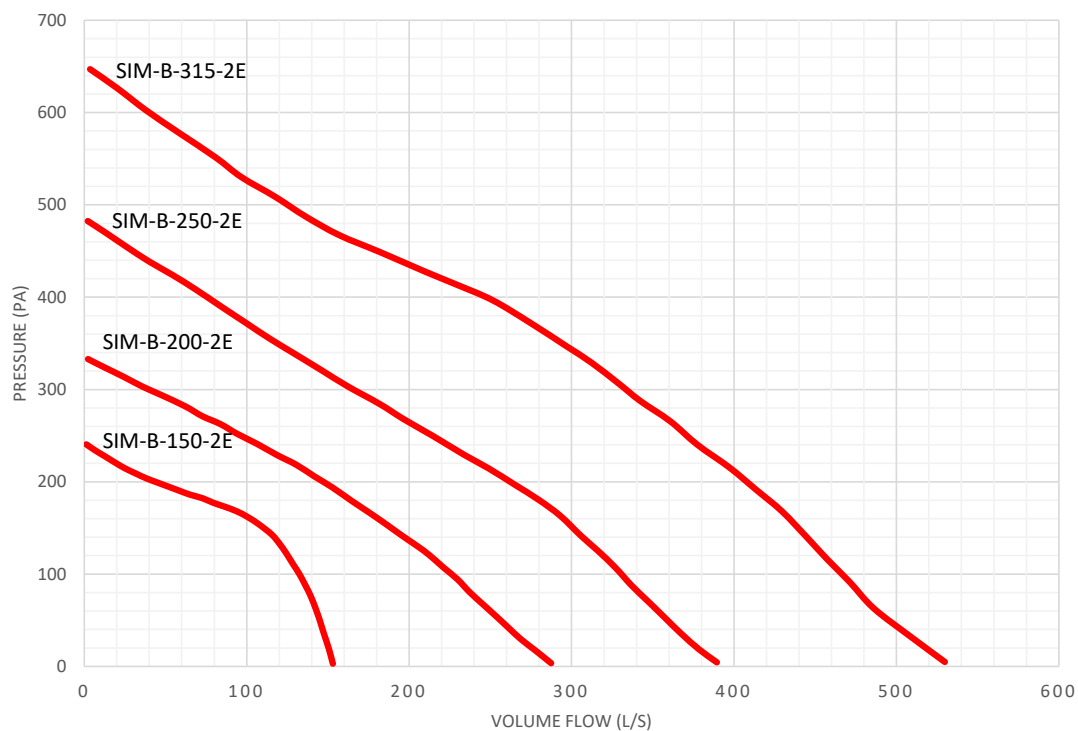

NOISE DATA

| | SPECTRUM (HZ) - SWL | 125 | 250 | 500 | 1K | 2K | 4K | 8K | DBA @ 3M - SPL |
|--------------|---------------------|-----|-----|-----|----|----|----|----|----------------|
| SIM-B-150-2E | Environment S1 | 56 | 50 | 43 | 38 | 30 | 23 | 18 | 25 |
| SIM-B-150-2E | Environment S2 | 63 | 57 | 50 | 45 | 35 | 27 | 22 | 32 |
| SIM-B-200-2E | Environment S1 | 62 | 55 | 47 | 41 | 38 | 36 | 29 | 31 |
| SIM-B-200-2E | Environment S2 | 68 | 61 | 52 | 45 | 42 | 40 | 33 | 36 |
| SIM-B-250-2E | Environment S1 | 64 | 60 | 50 | 44 | 38 | 32 | 24 | 34 |
| SIM-B-250-2E | Environment S2 | 65 | 62 | 56 | 49 | 45 | 40 | 30 | 37 |
| SIM-B-315-2E | Environment S1 | 63 | 61 | 53 | 45 | 42 | 38 | 28 | 35 |
| SIM-B-315-2E | Environment S2 | 37 | 63 | 58 | 50 | 47 | 44 | 34 | 38 |

TECHNICAL DATA

| MODEL | ELECTRICAL SUPPLY (V,PH,HZ) | MOTOR POWER (KW) | FULL LOAD CURRENT (A) | MOTOR POLES (EA) | FAN SPEED (RPM) | SPEED SETTING | MASS (KG) |
|--------------|-----------------------------|------------------|-----------------------|------------------|-----------------|---------------|-----------|
| SIM-B-150-2E | 240, 1, 50 | 0.045, 0.052 | 0.2, 0.23 | 2 | 1985, 2640 | 1,2 | 6.1 |
| SIM-B-200-2E | 240, 1, 50 | 0.078, 0.11 | 0.35, 0.49 | 2 | 2000, 2460 | 1,2 | 8 |
| SIM-B-250-2E | 240, 1, 50 | 0.127, 0.178 | 0.52, 0.79 | 2 | 1960, 2460 | 1,2 | 15 |
| SIM-B-315-2E | 240, 1, 50 | 0.213, 0.313 | 0.93, 1.41 | 2 | 2120, 2620 | 1,2 | 25 |





IM-B RANGE



FEATURES

The IM-B range is an all-round performer used for general ventilation. This fan comes in six different size options which provide varying rates of airflow.

APPLICATION

The IM-HG range is best applied in areas such as:

- Offices
- Bathrooms
- Kitchens

DIMENSIONS

| MODEL | B | D | D1 | H | L |
|-------------|-----|-----|-----|-----|-----|
| IM-B-100-2E | D | 98 | 164 | 241 | 303 |
| IM-B-125-2E | D1 | 123 | 164 | 241 | 258 |
| IM-B-150-2E | H | 148 | 187 | 251 | 289 |
| IM-B-200-2E | L | 199 | 209 | 261 | 296 |
| IM-B-250-2E | 287 | 247 | 257 | 323 | 383 |
| IM-B-315-2E | 362 | 310 | 323 | 408 | 445 |

HOW TO ORDER



CONSTRUCTION

This In-Line Mixed Flow Fan is manufactured from low-flammability polypropylene.

MOTORS

There is one motor option available for this size fan. This is a single-phase motor which has been pre-installed by the manufacturer. It also includes a 1.2 m power lead with a 3-pin plug.

SPECIAL FEATURES



IPX4 protection rating



High quality bearings



Quick release clamps



Two speed settings

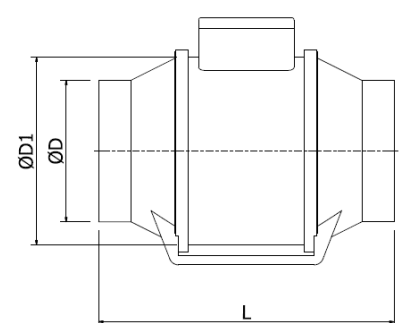
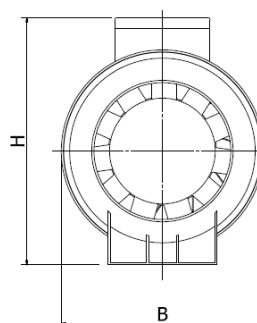

PERFORMANCE CURVE

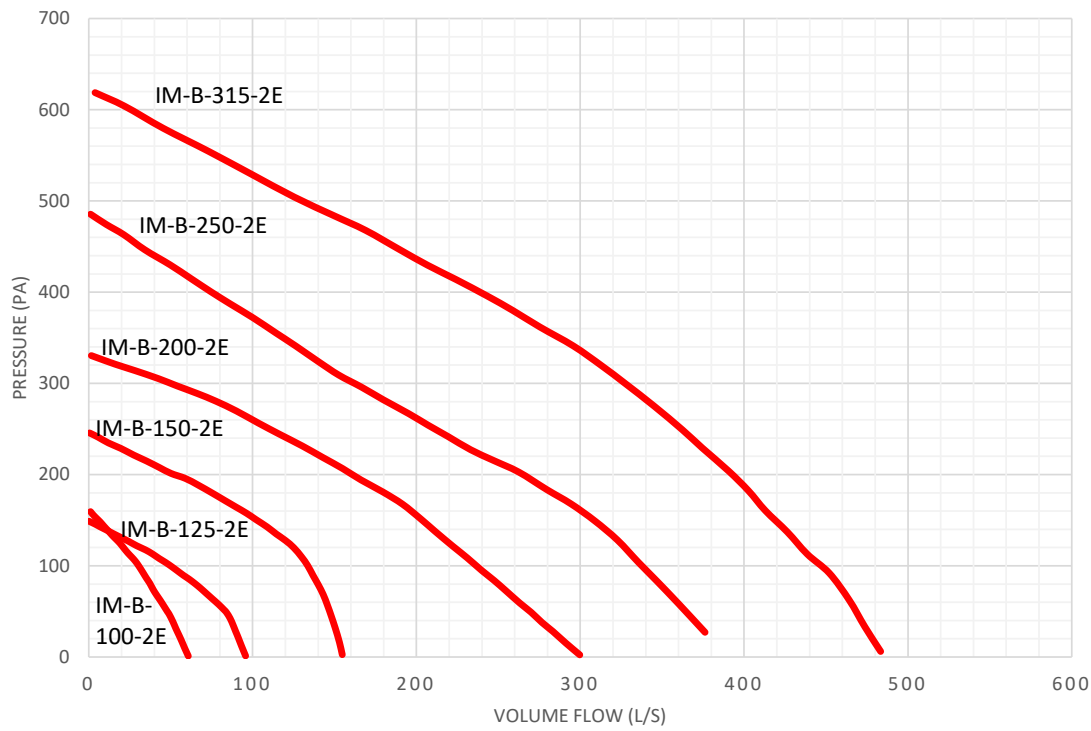

NOISE DATA

| | SPECTRUM (HZ) - SWL | 125 | 250 | 500 | 1K | 2K | 4K | 8K | DBA @ 3M - SPL |
|-------------|---------------------|-----|-----|-----|----|----|----|----|----------------|
| IM-B-100-2E | Environment S1 | 39 | 53 | 43 | 43 | 37 | 32 | 20 | 27 |
| IM-B-100-2E | Environment S2 | 45 | 62 | 54 | 50 | 44 | 39 | 25 | 36 |
| IM-B-125-2E | Environment S1 | 48 | 55 | 48 | 40 | 36 | 25 | 15 | 29 |
| IM-B-125-2E | Environment S2 | 43 | 59 | 49 | 47 | 46 | 37 | 23 | 33 |
| IM-B-150-2E | Environment S1 | 46 | 57 | 51 | 45 | 43 | 35 | 22 | 32 |
| IM-B-150-2E | Environment S2 | 53 | 65 | 62 | 57 | 62 | 48 | 34 | 45 |
| IM-B-200-2E | Environment S1 | 58 | 58 | 57 | 55 | 55 | 47 | 33 | 40 |
| IM-B-200-2E | Environment S2 | 59 | 63 | 63 | 60 | 61 | 54 | 40 | 46 |
| IM-B-250-2E | Environment S1 | 67 | 66 | 64 | 59 | 57 | 46 | 31 | 45 |
| IM-B-250-2E | Environment S2 | 66 | 72 | 72 | 66 | 64 | 54 | 39 | 52 |
| IM-B-315-2E | Environment S1 | 67 | 62 | 60 | 57 | 55 | 47 | 35 | 42 |
| IM-B-315-2E | Environment S2 | 67 | 75 | 69 | 67 | 66 | 59 | 47 | 52 |

TECHNICAL DATA

| MODEL | ELECTRICAL SUPPLY (V,PH,HZ) | MOTOR POWER (KW) | FULL LOAD CURRENT (A) | MOTOR POLES (EA) | FAN SPEED (RPM) | SPEED SETTING | MASS (KG) |
|-------------|-----------------------------|------------------|-----------------------|------------------|-----------------|---------------|-----------|
| IM-B-100-2E | 240, 1, 50 | 0.023, 0.025 | 0.1, 0.11 | 2 | 1980, 2545 | 1,2 | 1.68 |
| IM-B-125-2E | 240, 1, 50 | 0.025, 0.03 | 0.11, 0.13 | 2 | 1935, 2265 | 1,2 | 1.79 |
| IM-B-150-2E | 240, 1, 50 | 0.042, 0.05 | 0.18, 0.2 | 2 | 1940, 2620 | 1,2 | 3.18 |
| IM-B-200-2E | 240, 1, 50 | 0.076, 0.108 | 0.34, 0.48 | 2 | 1915, 2380 | 1,2 | 3.23 |
| IM-B-250-2E | 240, 1, 50 | 0.125, 0.177 | 0.54, 0.79 | 2 | 1955, 2440 | 1,2 | 7.83 |
| IM-B-315-2E | 240, 1, 50 | 0.227, 0.315 | 0.99, 1.42 | 2 | 2115, 2505 | 1,2 | 11.7 |



SIGRIST DESIGN^{PTY. LTD.}

HEAD OFFICE

Unit 3, 848 Boundary Road, Richlands,
QLD, 4077 Australia

EMAIL

sales@sigristdesign.com.au

PHONE

07 3271 4415

WWW.SIGRISTDESIGN.COM.AU

